

Land Registry  
Official Copy  
Title plan

Title number NTK387965  
Ordnance Survey map reference SE7783NE  
Scale 1:2500  
Administrative area North Yorkshire: Ryedale

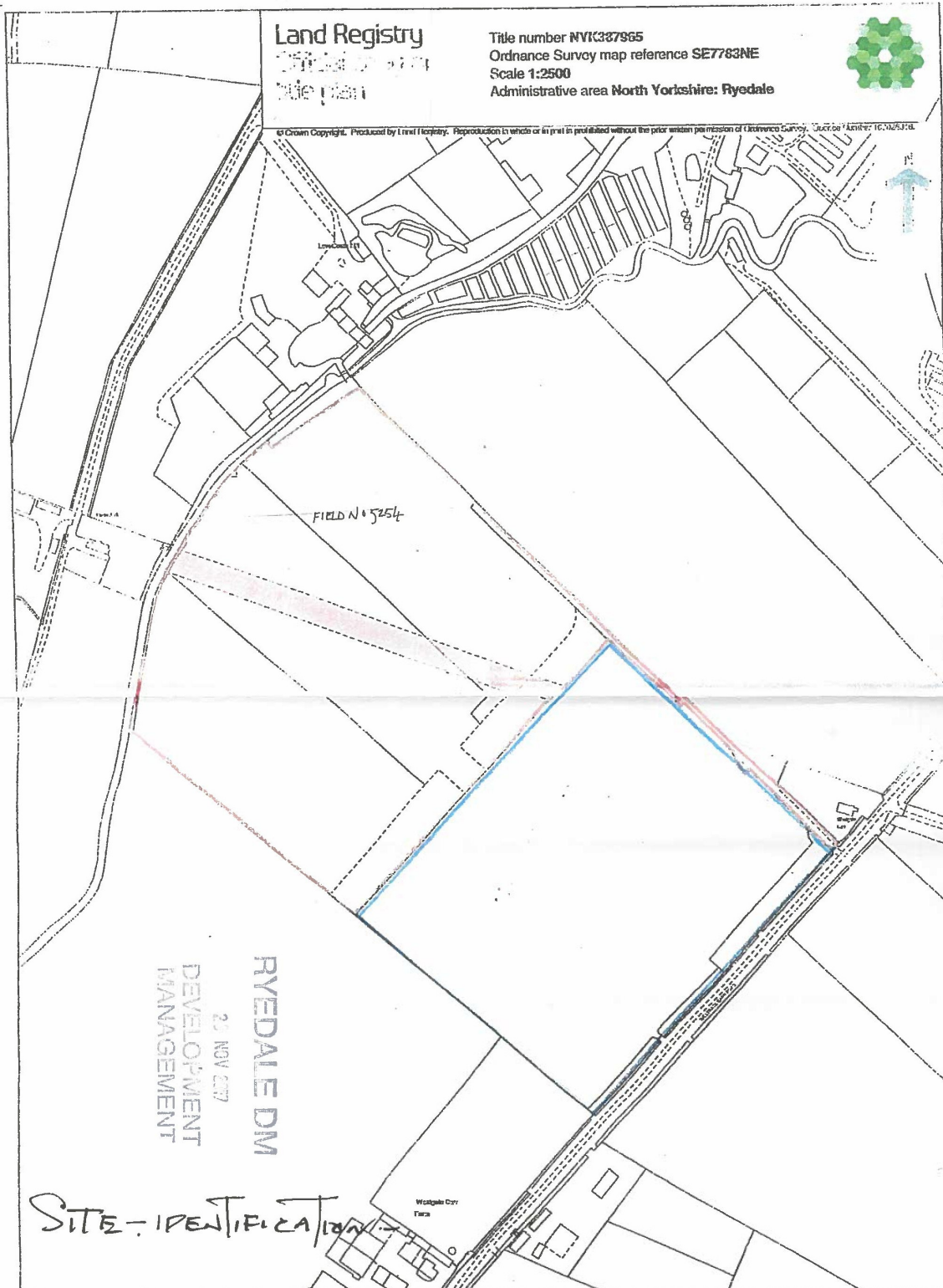

© Crown Copyright. Produced by Land Registry. Reproduction in whole or in part is prohibited without the prior written permission of Ordnance Survey. Licence Number: 100025376



This official copy issued on 4 July 2011 shows the site of this title plan on 4 July 2011 at 16:06:49. It is admissible in evidence to the same extent as the original (s.07 Land Registration Act 2002).

This title plan shows the general position, not the exact line, of the boundaries. It may be subject to distortions in scale. Measurements scaled from this plan may not match measurements between the same points on the ground. See Land Registry Public Guide 19 - Title Plans and Boundaries.

This title is dealt with by Land Registry, Durham Office.

THIS COPY HAS BEEN MADE BY OR WITH THE AUTHORITY OF RYEDALE DISTRICT COUNCIL PURSUANT TO SECTION 47 OF THE COPYRIGHT, DESIGNS AND PATENTS ACT 1988 (UNLESS THAT ACT PROVIDES A RELEVANT EXCEPTION TO COPYRIGHT, THE COPY MUST NOT BE COPIED WITHOUT THE PRIOR PERMISSION OF THE COPYRIGHT OWNER)

3